

# V-VL SERIES

TRAY LOADERS



# V-VL SERIES

TO COMPLETE THE PANORAMA OF PRODUCTION LINES FOR ASEPTIC PRODUCTS, WHERE MINIMUM OPERATOR INTERVENTION IS ESSENTIAL, IMA LIFE MANUFACTURES A WIDE RANGE OF TRAY LOADERS FOR THE AUTOMATION OF TRADITIONAL MANUAL OPERATIONS.

The automatic tray loaders of the V and VL series are the ideal solution for loading vials onto plastic, metal or paperboard trays, including lyophiliser trays.

The range includes the following models:

- V300 M single station and one tray
- V300 single station and two trays
- V600 double station and four trays
- VL200 in-line compact tray loader
- VL400 and VL600 in-line twin tray loaders.



## MAIN FEATURES

- NO MECHANICAL PARTS IN CONTACT WITH VIAL MOUTH OR CAP TO AVOID ANY DAMAGE OR CONTAMINATION
- HIGH PERFORMANCE WITH BOTH SVP (SMALL VOLUME) AND LVP (LARGE VOLUME) VIALS AT HIGH SPEED
- SUITABLE FOR CLEAN ROOM ENVIRONMENTS: STAINLESS STEEL FINISHING COMBINED WITH COMPONENTS COMPATIBLE WITH STERILISING AGENTS
- USER-FRIENDLY HMI TO SET OUTPUT RATE, SELECT FORMAT AND NUMBER OF ROWS ON EACH TRAY
- HIGH FLEXIBILITY AND SIMPLE CHANGEOVER BY MEANS OF CALIBRATED MECHANICAL ADJUSTMENTS





## V SERIES

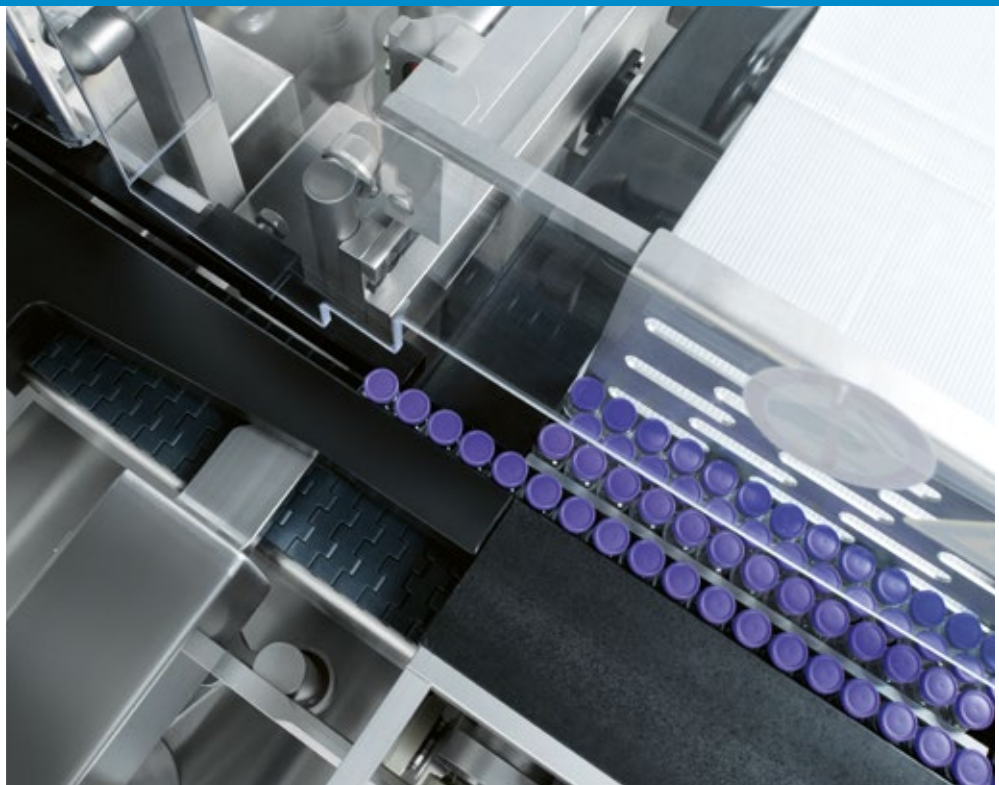

The tray loaders of the V series are equipped with one or two loading positions. On the V300 (single station) they accommodate two trays, one at a time, while on the V600 (double station) they accommodate four trays, two at a time.

The vials can be loaded in staggered rows to optimise tray capacity and consequently lyophiliser capacity, in the case of freeze dryer loading.

Final row counting and automatic tray selection are vital to improve lyophilisation operations. Counters are provided for number of vials and number of rows.

Upon request, the machine can be equipped with brushless motors for installation in sterile environments or for high outputs.

A vision system can be integrated in each tray loader for final reconciliation of the production.

## VL SERIES

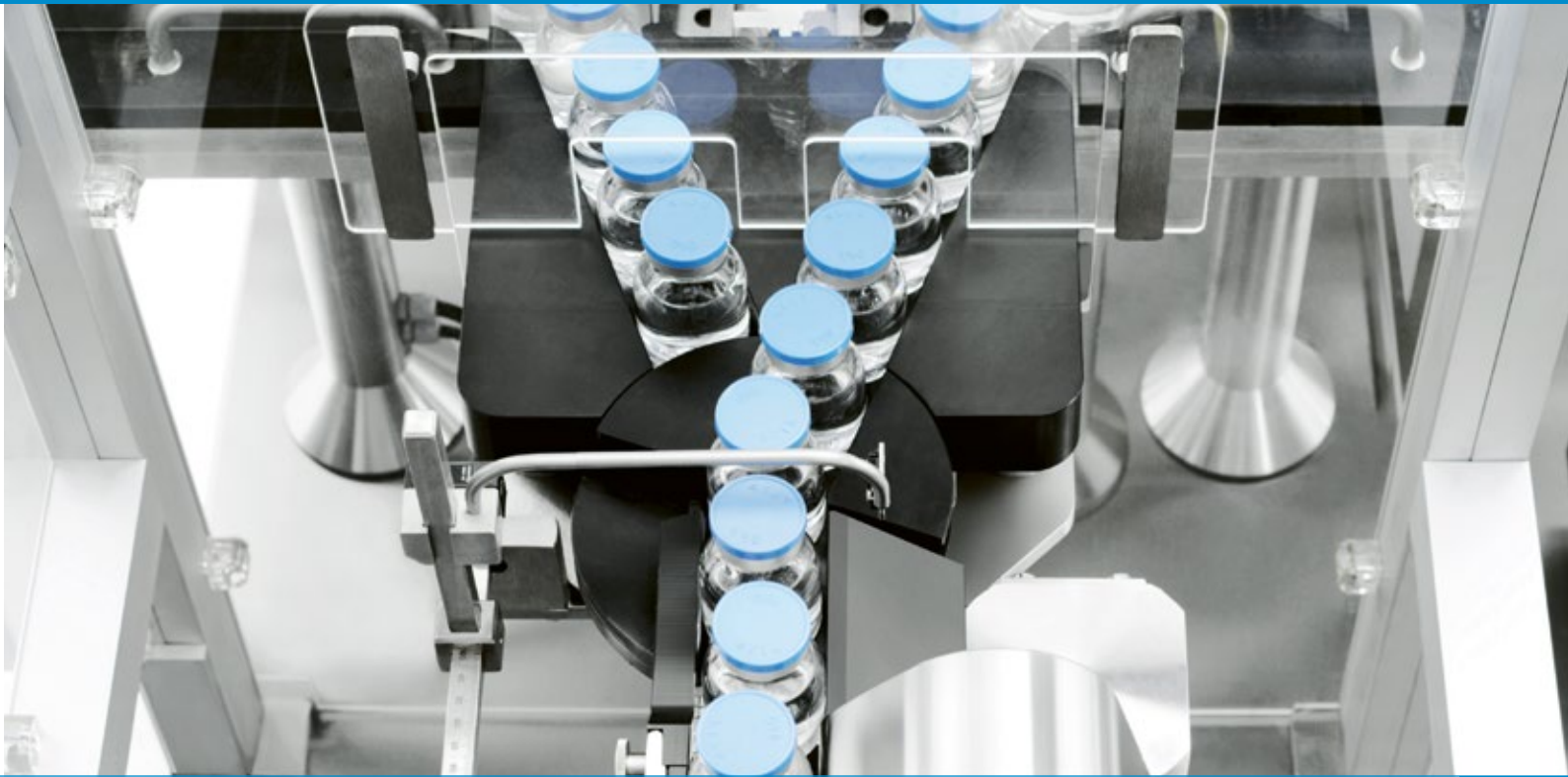

The VL series of tray loaders includes VL200 with compact dimensions and VL400-VL600 twin tray loaders. All models are designed to be installed in line with other machines.

The VL200 is extremely compact and its flexibility lies in being suitable for small volume vials at low-medium speed as well as large volume vials at lower speed. A scroll guides the vials to the trays where they are loaded with minimum operator intervention.

The VL400 and VL600 accommodate two trays. Vials are fed by means of a scroll. At discharge, a switching device guides the vials from one tray to the other when the required vial count in the tray has been reached.

The switching device is PLC-controlled and the scroll is spring-loaded to signal an emergency stop in the event of a fallen vial entering the machine.

# TECHNICAL DATA

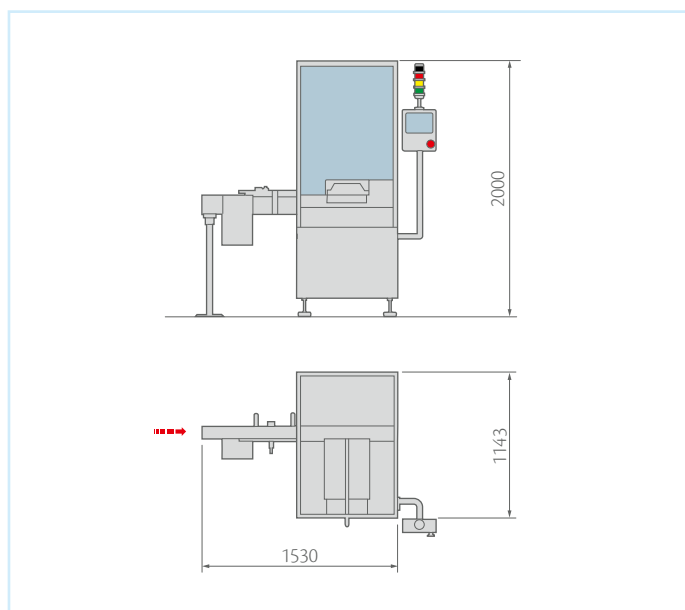

MODEL	V300 M
Output (strokes/minute)*	19 or 27**
Standard voltage	400 V-50 Hz
Installed power (kW)	1
Bottle size	Ø 14 to 52 mm Maximum height 120 mm SVP
Tray dimension (mm)	n. 1 standard 350 x 500

\* Depending on vial diameter and tray size

\*\* 27 only for brushless version

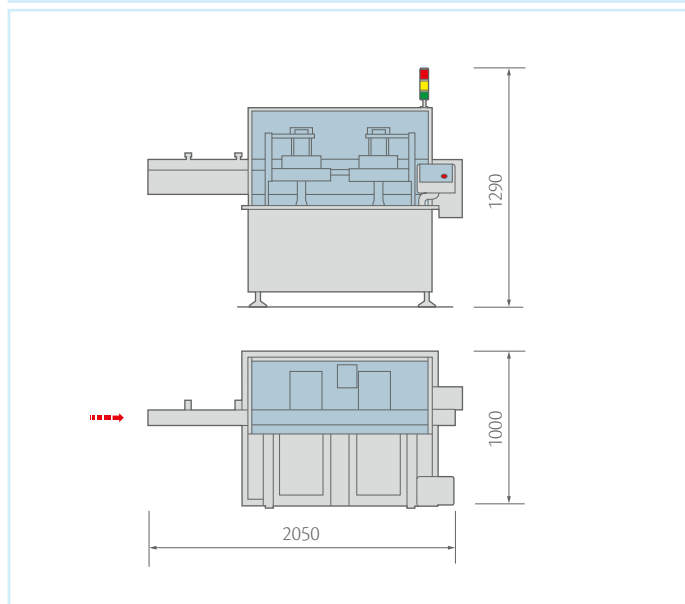

MODEL	V300
Output (strokes/minute)*	19 or 27**
Standard voltage	400 V-50 Hz
Installed power (kW)	1
Bottle size	Ø 14 to 52 mm Maximum height 120 mm SVP
Tray dimension (mm)	n. 2 standard 350 x 500

\* Depending on vial diameter and tray size

\*\* 27 only for brushless version

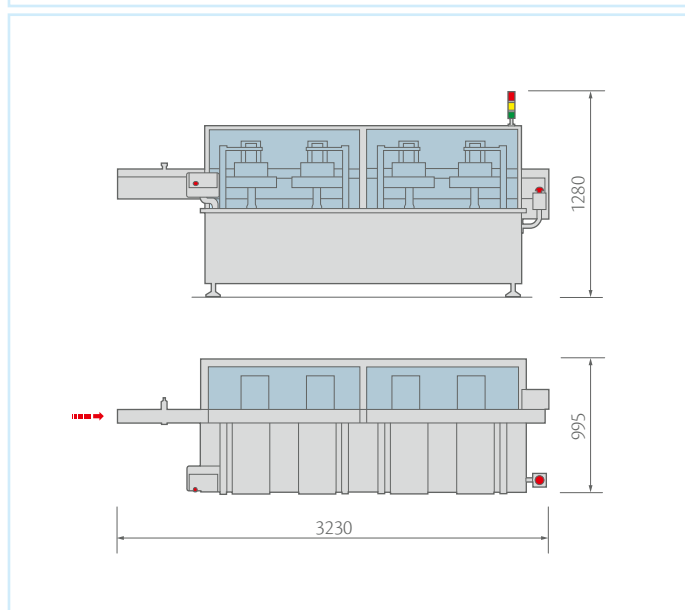

MODEL	V600
Output (strokes/minute)*	19 or 27**
Standard voltage	400 V-50 Hz
Installed power (kW)	1.5
Bottle size	Ø 14 to 52 mm Maximum height 120 mm SVP
Tray dimension (mm)	n. 4 standard 350 x 500

\* Depending on vial diameter and tray size

\*\* 27 only for brushless version

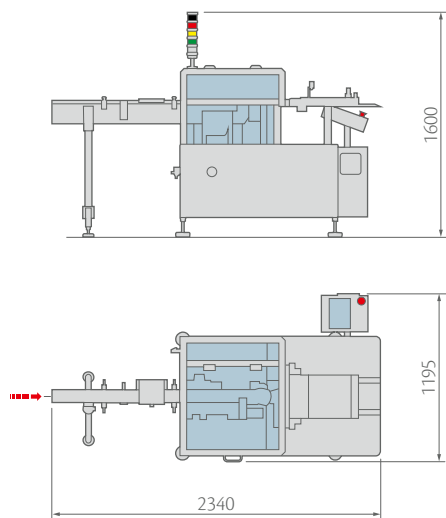

MODEL	VL200
Output (pieces/minute)	200
Standard voltage	400 V - 50 Hz
Installed power (kW)	1
Bottle size	Ø 16 to 52 mm Maximum height 180 mm
Tray dimension (mm)	n. 1 - 350 x 500

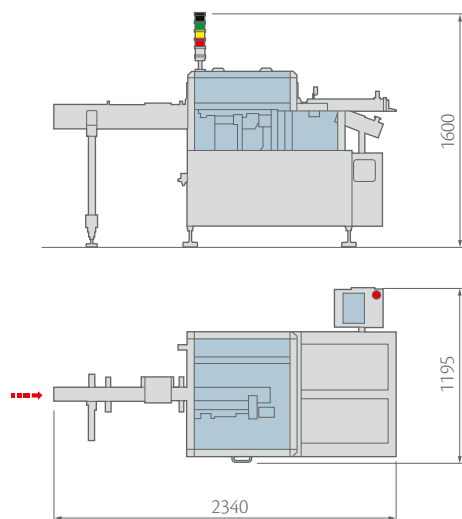

MODEL	VL400
Output (pieces/minute)	400
Standard voltage	400 V - 50 Hz
Installed power (kW)	1
Bottle size	Ø 16 to 36 mm** Maximum height 130 mm
Tray dimension (mm)	n. 2- 350 x 500

\*\*Up to 52 mm with single tray

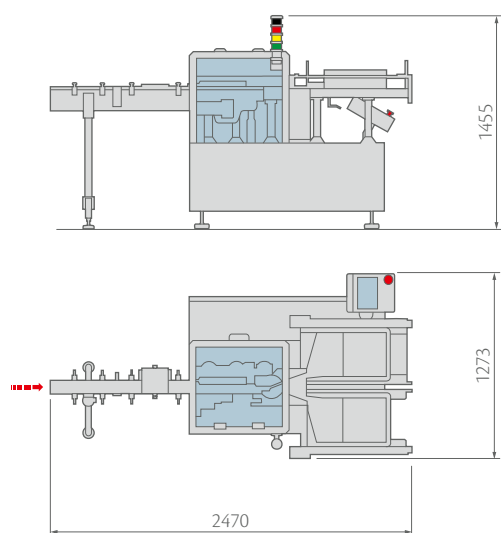

MODEL	VL600
Output (pieces/minute)	600
Standard voltage	400 V - 50 Hz
Installed power (kW)	1
Bottle size	Ø 16 to 52 mm Maximum height 130 mm
Tray dimension (mm)	n. 2 - 350 x 500

ima.it

